

RHBABY&CHILD  
RHTEEN

VALENTINA UPHOLSTERED PLATFORM BED WITH PLINTH BASE – FULL, QUEEN

ASSEMBLY AND INSTALLATION INSTRUCTIONS

**ENGLISH**

**VALENTINA UPHOLSTERED PLATFORM BED WITH  
PLINTH BASE – FULL, QUEEN**

**PARTS INCLUDED**

- (A) Headboard (1)
- (B) Side Rails (2)
- (C) Footboard (1)
- (D) Slats (4)
- (E) Platform Panels (2)
- (F) High Center Support Slat Feet (4)

**HARDWARE INCLUDED**

- (1) Threaded Rods (8)
- (2) Curved Washers (8)
- (3) Lock Washers (8)
- (4) Nuts (8)
- (5) Spanner Wrench (1)
- (6) Screws (3cm) (16)
- (7) Screws (4cm) (8)

**TOOLS NEEDED**

Phillips screwdriver (not included)

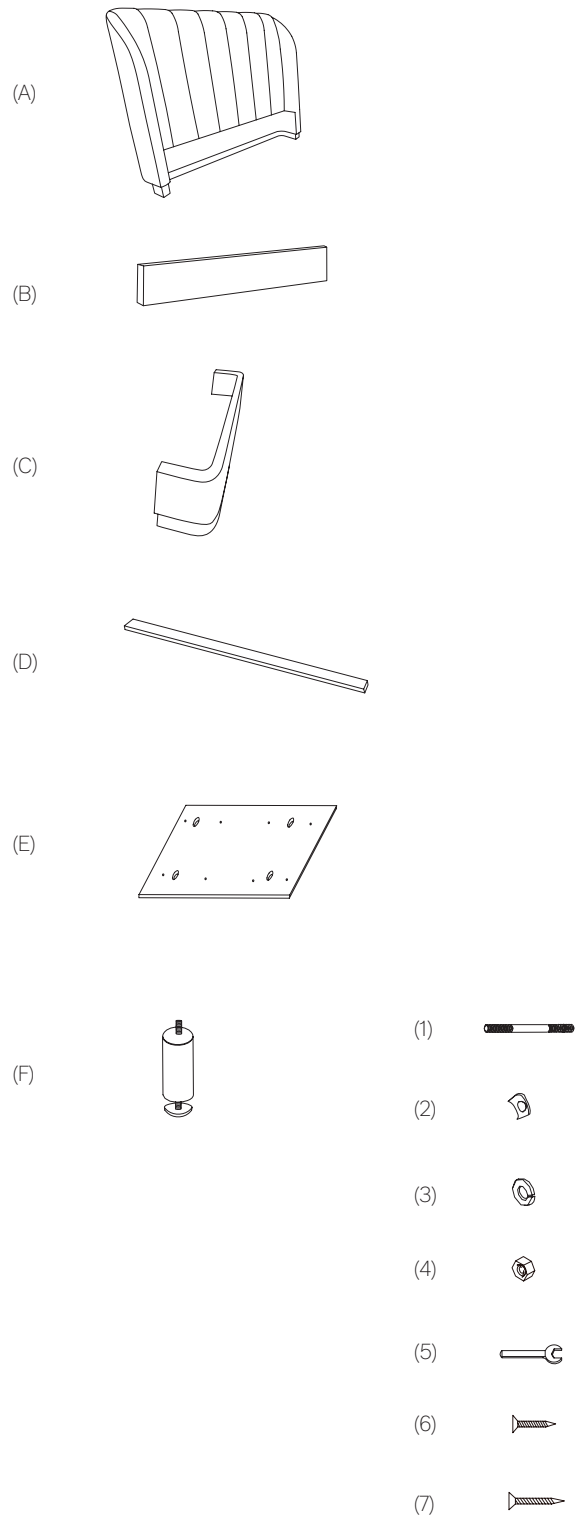

**SAFETY INSTRUCTIONS**

Bed must be assembled by at least two people.  
 Please read instructions carefully before assembling bed.  
 Use the above parts and hardware list to identify each component.  
 Keep all packing materials until assembly is complete to avoid loss of smaller parts.

**ASSEMBLY INSTRUCTIONS**

1. Place Headboard (A) upright in the position you wish the bed to be in when fully assembled. Secure Threaded Rods (1) to the fixed nuts on Headboard (A) by screwing it in by hand.

2. Raise the Side Rails (B) up and align Threaded Rods (1) with the bore holes on the end of the Side Rails (B). Place Side Rails (B) up against Headboard (A) so Threaded Rods (1) go through the holes. Insert Curved Washers (2), Lock Washers (3), and Nuts (4). Then secure with Spanner Wrench (5), as shown in Diagram I.
3. Repeat steps 1 and 2 to install Footboard (C) to Side Rails (B).
4. Attach Center Support Feet (F) to Slats (D), as shown in Diagram II.
5. Place Slats (D) to the top of Side Rails' (B) side slats and fasten using Screws (7), as shown in Diagram III.
6. Lay Platform Panels (E) on top of Slats (D) and fasten using Screws (6), as shown in Diagram IV.
7. Assembly is complete.

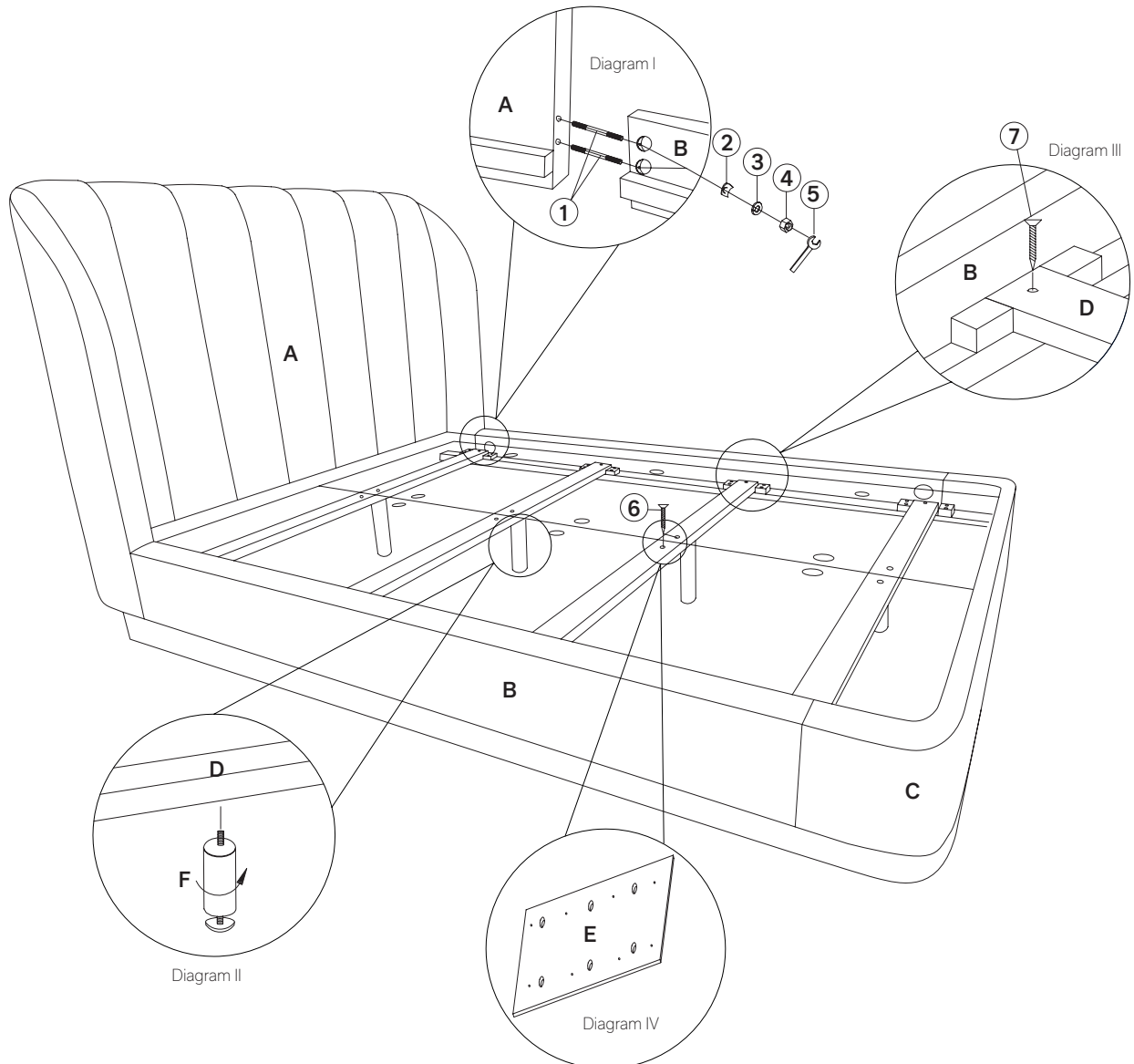

**WARRANTY**

If you are not completely satisfied with your purchase, please contact us to return or exchange your item(s) within 30 days of the delivery date, with proof of purchase. Note that returns or exchanges are not accepted for special orders, items that have been installed, mattresses and/or foundations no longer in their original packaging, and other items listed at RH.com. Other exclusions may apply. Contact us for details. Unfortunately, galleries cannot accept returns of furniture or other large items.

**CARE INSTRUCTIONS**

Spot clean only with a soft, damp cloth.